

**TENANT DATA**

95 AMEDISYS, INC.	+/- 2928 sq.ft.
96 VEEN SCHOTEN AND COMPANY, INC.	+/- 1905 sq.ft.
100 PINNACLE OPTICAL, LLC.	+/- 1208 sq.ft.
105 STAFF MARK	+/- 1509 sq.ft.
107 WESTERN FUNDING	+/- 1227 sq.ft.
108 MOSES O. STONE	+/- 255 sq.ft.
109 EDWARD P. JONES	+/- 186 sq.ft.
110 COLLATERAL BENEFITS GROUP	+/- 1592 sq.ft.
111 LAYTON ENVIRONMENTAL ENGINEERING	+/- 448 sq.ft.
112 PATRICIA N. MOORE	+/- 949 sq.ft.
113 PHASE 1 BUILDERS / MORRO LAW	+/- 609 sq.ft.
114 LAYTON ENVIRONMENTAL ENGINEERING	+/- 706 sq.ft.
115 KAREN MORRIS	+/- 1114 sq.ft.
117 RUSH INITIATIVE	+/- 689 sq.ft.

**GLA +/- 15325 sq.ft.**

**AVAILABLE SPACE**

98 AVAILABLE	+/- 433 sq.ft.
99 AVAILABLE	+/- 172 sq.ft.
116 AVAILABLE	+/- 198 sq.ft.

**GLA +/- 803 sq.ft.**

**TOTAL GLA +/- 16128 sq.ft.**

FOR PRINT SIZE 11" X 17"

SCALE 1/16" = 1'-0"

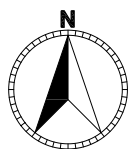
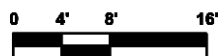

# 1900 Crestwood Boulevard • first floor

Irondale, AL 35216

## Collateral Properties

1900 Crestwood Blvd., Suite 300 • Irondale, AL 35210

**Tom Coggin**

205-951-1015

tcoggin@collateralproperties.com

**Bryan Ratliff**

205-951-4488

bratliff@collateralproperties.com

No warranty or representation, expressed or implied, is made as to the accuracy of the information contained herein. Such information is submitted subject to change in price, errors, omission, and withdrawal with out prior notice. **This document is not for construction purposes.**



FOR PRINT SIZE 11" X 17"

SCALE 1/16" = 1'-0"

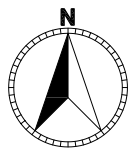
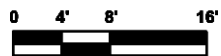

FRONT PARKING

**TENANT DATA**

200 CONTECH	+/- 1414 sq.ft.
201 COLLATERAL INC. (W. RATLIFF)	+/- 819 sq.ft.
203 TRANSPORTATION CONCEPTS, INC.	+/- 2299 sq.ft.
207 STRINGFELLOW LUMBER CO.	+/- 2365 sq.ft.
207 STRINGFELLOW LUMBER CO. (CONT.)	+/- 2141 sq.ft.
211 TOOTHZONELL	+/- 1748 sq.ft.
211-A VITAL MANAGEMENT GROUP	+/- 2106 sq.ft.
212 BOWMAN SERVICES	+/- 425 sq.ft.

**GLA +/- 13317 sq.ft.**

**AVAILABLE SPACE**

202 AVAILABLE	+/- 862 sq.ft.
205 AVAILABLE	+/- 505 sq.ft.
213 AVAILABLE	+/- 952 sq.ft.
AVAILABLE	+/- 207 sq.ft.
AVAILABLE	+/- 249 sq.ft.

**GLA +/- 2775 sq.ft.**

**TOTAL GLA +/- 16092 sq.ft.**

# 1900 Crestwood Boulevard • second floor

Irondale, AL 35216

## Collateral Properties

1900 Crestwood Blvd., Suite 300 • Irondale, AL 35210

**Tom Coggin**

205-951-1015

tcoggin@collateralproperties.com

**Bryan Ratliff**

205-951-4488

bratliff@collateralproperties.com

No warranty or representation, expressed or implied, is made as to the accuracy of the information contained herein. Such information is submitted subject to change in price, errors, omission, and withdrawal with out prior notice. **This document is not for construction purposes.**

SIDE PARKING

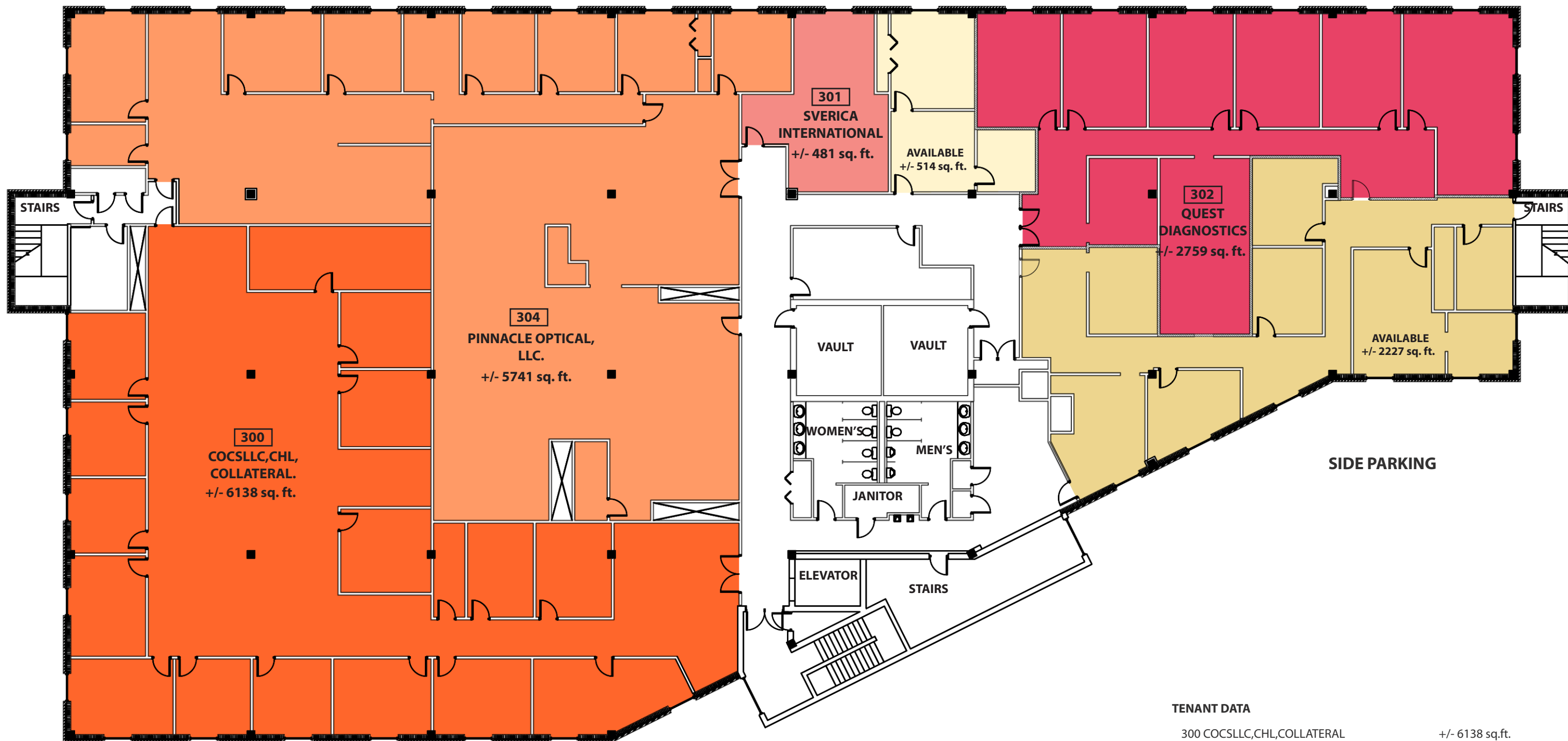

FOR PRINT SIZE 11" X 17"

SCALE 1/16" = 1'-0"

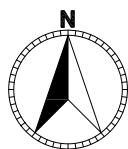
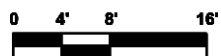

FRONT PARKING

**TENANT DATA**

300 COCSLLC, CHL, COLLATERAL	+/- 6138 sq.ft.
301 SVERICA INTERNATIONAL	+/- 481 sq.ft.
304 PINNACLE OPTICAL LLC.	+/- 5741 sq.ft.
302 QUEST DIAGNOSTICS	+/- 2759 sq.ft.

<b>AVAILABLE SPACE</b>	<b>GLA</b>	<b>+/- 15119 sq.ft.</b>
302 AVAILABLE		+/- 514 sq.ft.
AVAILABLE		+/- 2227 sq.ft.
	<b>GLA</b>	<b>+/- 2741 sq.ft.</b>
	<b>TOTAL GLA</b>	<b>+/- 17860 sq.ft.</b>

# 1900 Crestwood Boulevard • third floor

Irondale, AL 35216

## Collateral Properties

1900 Crestwood Blvd., Suite 300 • Irondale, AL 35210

**Tom Coggin**

205-951-1015

tcoggin@collateralproperties.com

**Bryan Ratliff**

205-951-4488

bratliff@collateralproperties.com

No warranty or representation, expressed or implied, is made as to the accuracy of the information contained herein. Such information is submitted subject to change in price, errors, omission, and withdrawal with out prior notice. **This document is not for construction purposes.**