

OFFICE SPACE FOR LEASE



1900 Crestwood Irondale, AL 35210

Located in the heart of Irondale, Alabama. This 3-story building is conveniently located next to Interstates 20 and 459. A ten minute drive from downtown Birmingham.

Leasing Information:

Bryan Ratliff
205-951-4488
bratliff@collateralproperties.com

Tom Coggin
205-951-1015
tcoggin@collateralproperties.com

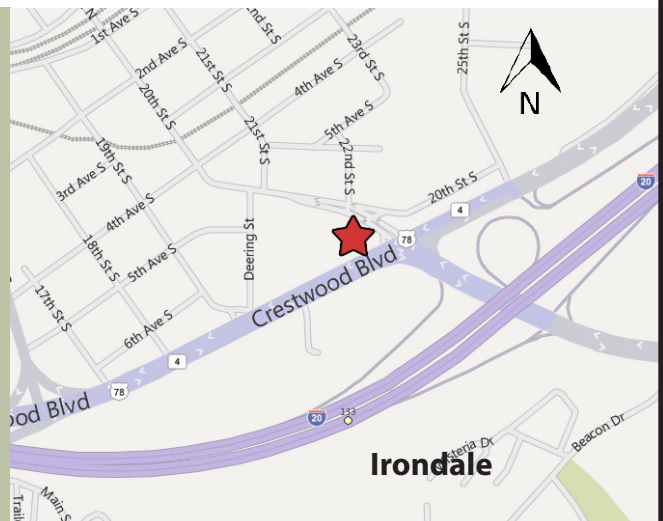

Collateral Properties

1900 Crestwood Blvd., Suite 300 • Irondale, AL 35210

No warranty or representation, expressed or implied, is made as to the accuracy of the information contained herein. Such information is submitted subject to change in price, errors, omission, and withdrawal with out prior notice.