



# Lorna Professional Building

3021 Lorna Road • Birmingham, AL 35216

## Office Space for Lease

Lorna Professional is three-story, multi-tenant office building conveniently located close to Highway 31 and Interstate 459 & 65.

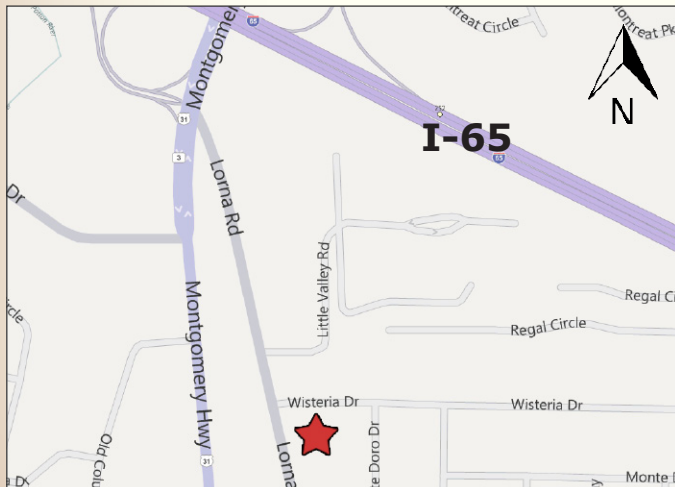

Collateral Properties • 1900 Crestwood Blvd., Suite 100 • Irondale, AL 35210

### Leasing Information:

**Tom Coggin**

205-951-1015

tcoggin@collateralproperties.com

**Bryan Ratliff**

205-951-4488

bratliff@collateralproperties.com

No warranty or representation, expressed or implied, is made as to the accuracy of the information contained herein. Such information is submitted subject to change in price, errors, omission, and withdrawal with out prior notice.